

ECOTRAVERS®

INSTRUCTIONS FOR THE INSTALLATION

terrace made of
composite cladding boards

www.ecotravers.pl

tokada



Table of contents

Safety measures	p. 3
Elements of the system	p. 4
List of the tools necessary for the installation	p. 5
Types and preparation of the base for the installation	p. 5
Assembly of joists	p. 6-7
Assembly of boards	p. 8
Drilling the joist and milling the hole	p. 8
Installation of the joist to the base for quick assembly dowels	p. 8
Drilling of the joist for the starter clip	p. 9
Installation of the starter clip	p. 10
Assembly of the first board	p. 10
Screwing of the board	p. 11
Assembly of further boards	p. 11
Alternating installation	p. 12
Finishing at the door and windows	p. 12
Wooden blocks	p. 13
Finishing with a corner slat of the window opening	p. 13
Finishing with a corner slat	p. 14
Installation with thermal insulation	p. 15



Thank you for trusting us and purchasing our products. Before commencing with the work, read the entire manual.

SAFETY MEASURES



Installation should be carried out by specialized construction companies. Ecotravers is not liable for any loss or damage to the product resulting from faulty installation. The installation not following the instructions set forth below deprives the consumer of the right to the warranty.



The boards should not be installed during rainfall and at temperatures below 5 degrees C. Before commencing with the installation, all boards and profiles should undergo 24-hour acclimatization in the place of installation.



For cutting the elements produced by Ecotravers, we recommend using a fine toothed or diamond cut metal / aluminum circular saw.

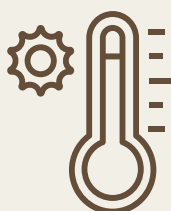

Like natural wood, composite materials are subject to natural shrinkage and expansion due to changing weather conditions, so remember to leave an expansion joint (2mm per 1 linear meter).

SYSTEM COMPONENTS

The terrace system includes the following elements:

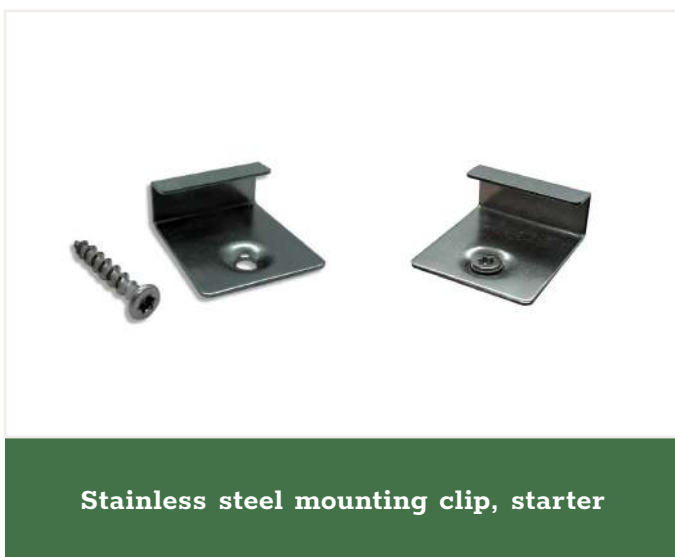

* recommended for window openings and doors that require a masking strip.

List of tools necessary for assembly

- Miter or table saw - preferably with a metal / aluminum blade with fine toothing or diamond finish
- Hammer drill for fastening joists to concrete
- Screwdriver - for the ease of installation, we recommend using two screwdrivers - one for drilling and the other for screwing
- Engineers' hammer and rubber mallet
- Spirit level
- Pencil
- Measure
- Set of drill bits: 6 mm for concrete, 6 mm for metal and 3 mm for metal
- Screwdriver cutter (conical chamfer)
- Torx T15 bit
- Glue (optional)
- Quick installation or expansion plugs
- Screws for dowels

Types and preparation of the base for installation

Ecotravers Tokada facade boards should be installed on the substrate that has been prepared beforehand. The substrate should be flat and durable. The substrate should comply with applicable laws and with the construction practice.

This manual applies to the installation of the elevation board on a concrete substrate in a horizontal arrangement. If needed, the boards can also be installed in a vertical arrangement and on other types of ground.

The facade boards can be used for installation on:

- ✓ concrete wall
- ✓ wooden openwork
- ✓ structure wall
- ✓ wall with thermal insulation
- ✓ wall insulated with polystyrene - point and whole wall installation

A description of a sample installation of the facade board on a wall with thermal insulation is available at the end of the manual.

In the case of installation extending beyond the structure the building, remember to protect it against stains in accordance with the construction practice.

While installing the boards directly on the wall, there is a possibility of additional insulation with mineral wool with a thickness of 30 mm inside the installation.

Installation of joists

Joists should be installed with wall plugs suitable for quick installation. The distance between the pins should not be greater than 350mm.



Placing the joists on the wall

The wall should be stable and flat. The joists should be placed parallel to one another at maximum intervals of 350 mm from the center, with deep grooves upwards. 10 mm wide expansion gaps should be left between the joist and the ground.

Installation of joists

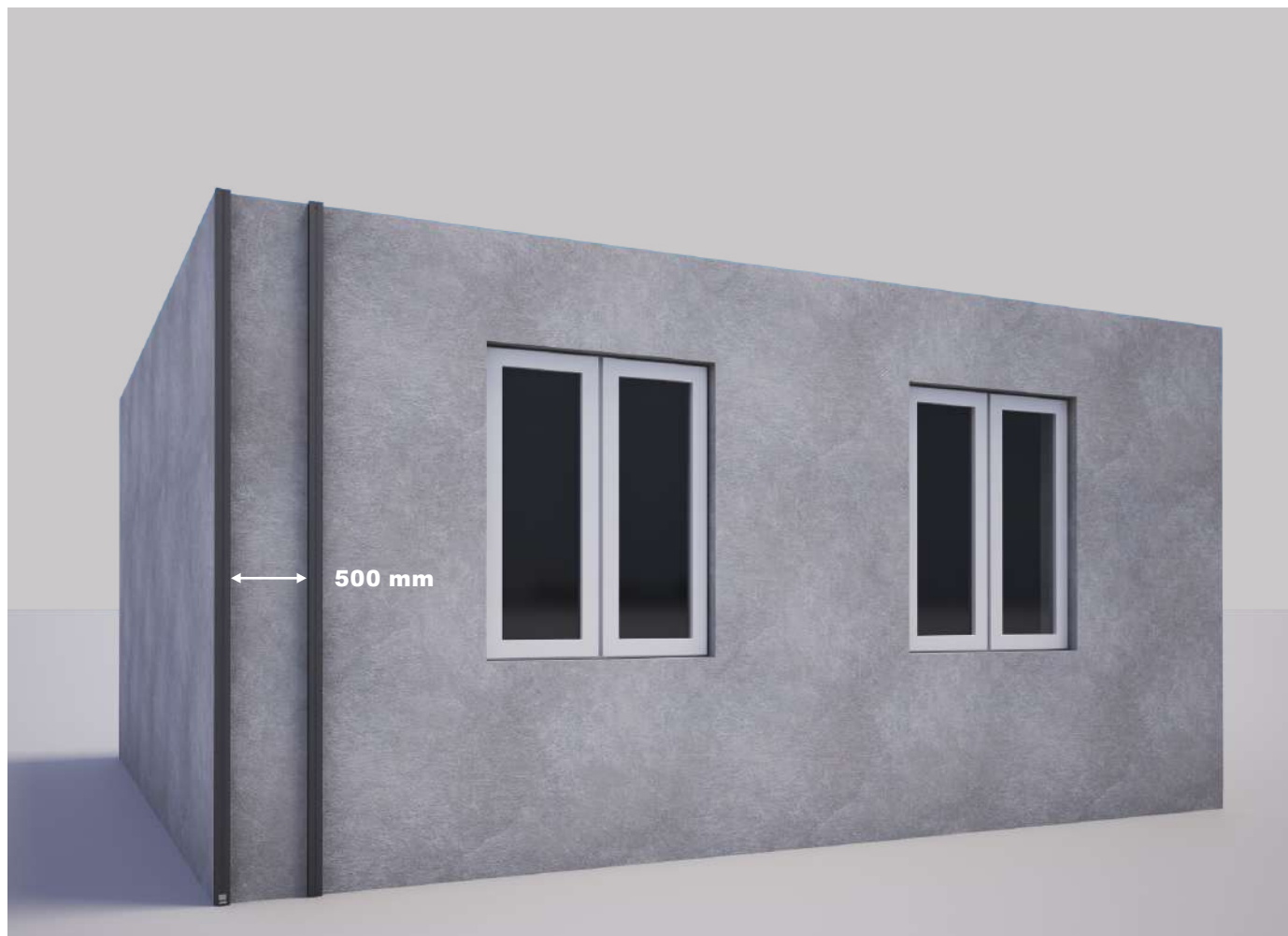

Before installation, remember:

- The joists cannot be embedded in the concrete
- The maximum distance between the joists must not be greater than 500 mm
- The substrate should be made in accordance with the generally accepted regulations and construction practice.



Installation of boards

Remember about milling!

01

Joist drilling and hole milling

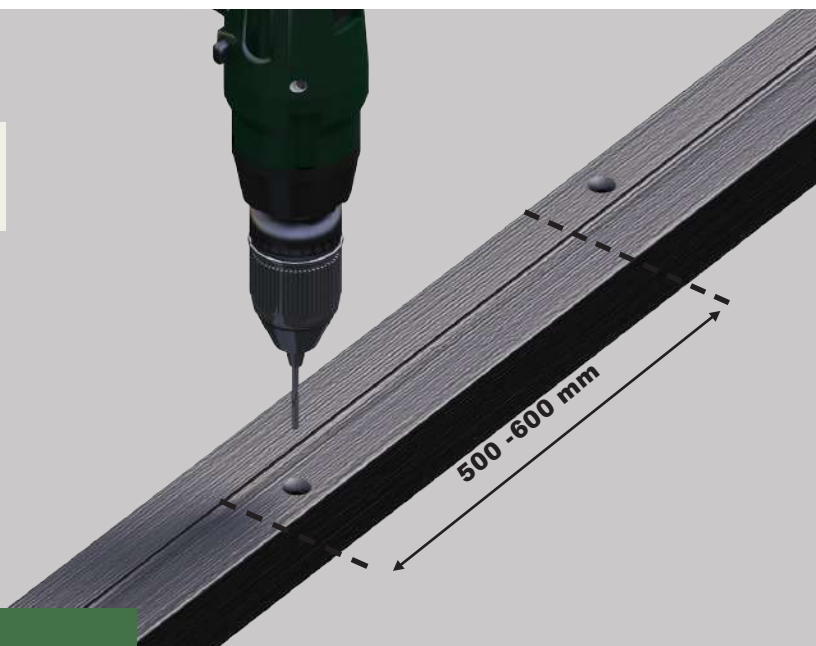

First, drill the joist with a 6 mm metal drill, then put the joist to the wall and mark the place of drilling in the wall. After removing the joist, drill a hole in the substrate at approx. every 500-600 mm. Drill the holes in the joist in an alternating manner, as indicated in the picture above. Before installing the dowels, the holes should be milled with a countersink.

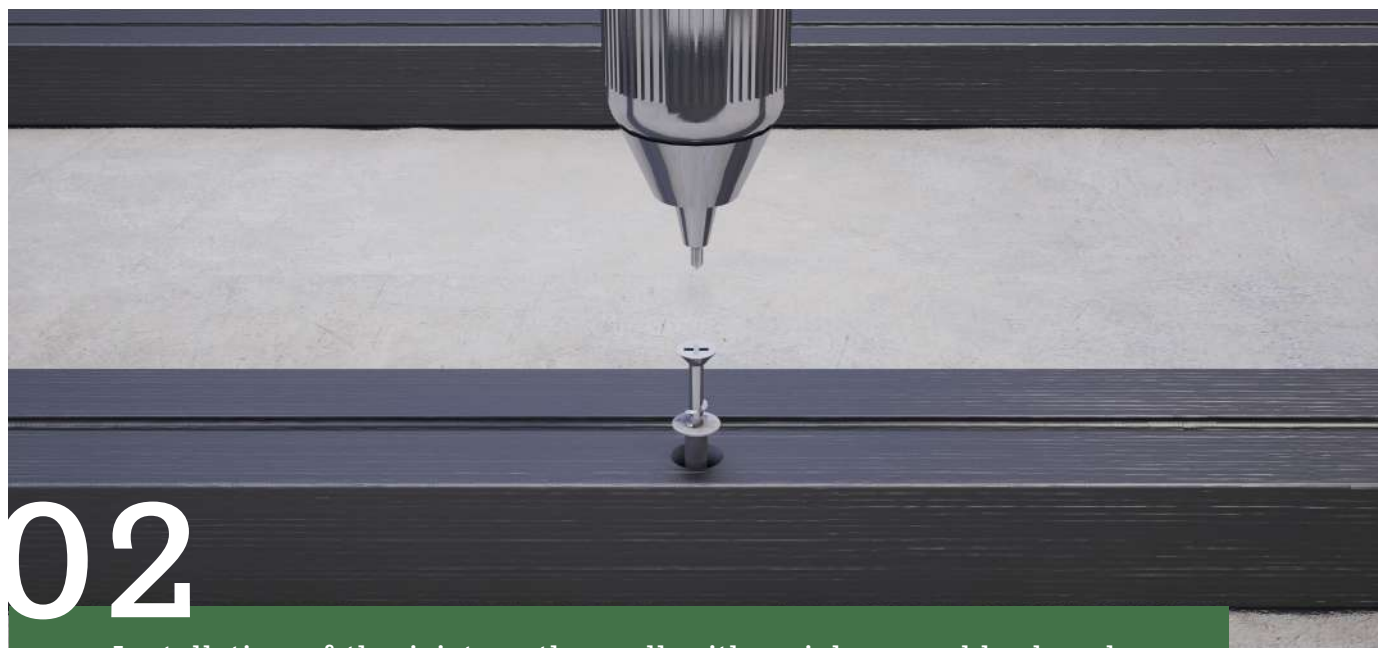

02

Installation of the joist on the wall with quick-assembly dowels

Joists should be installed with wall plugs suitable for quick installation 6 x 60 mm or 6 x 80mm depending on your needs.

Expansion gaps

- During the installation of composite elements, always pay attention to their shrinkage and expansion depending on weather conditions.
- The WPC composite retains similar properties to natural wood and therefore it is necessary to use expansion joints between the materials during installation.



Drilling the joist for the starter clip

Drill a guide hole with a 3 mm metal drill in the centre of the joist. Failure to drill the joist may result in faulty installation of the clip and its uneven adhesion. The hole should be drilled 35mm from the edge of the joist



Fix the starting blocking clip 15mm from the edge of the joist using the attached screws. The embossing in the clip should fit into the groove in the joist.



The first elevation board should be inserted into the starting clips. The clips will provide support when screwing the first board.



06

Installation of the first board

The boards are attached to the joist structure with screws. Prior to screwing, make a leading hole with a 3 mm metal drill in the plank and in the joist, to about half the depth of the joist. Lack of drilling may result in faulty installation of the board and its uneven adhesion.



07

Installation of other boards

Kolejną deskę nakładamy na pierwszą. Deski posiadają pióro i wpust. Stosowany jest tu montaż ukryty bez widocznych wkrętów, a dzięki lekkiemu machyleniu zabezpieczają podłoże przed opadami atmosferycznymi.



08

Alternate layering

While connecting boards of different lengths, it is recommended that they should be laid alternately, with the use of the so-called „Alternate layering“. The ends of the boards must rest on separate joists and be fastened with separate screws. There should be a minimum dilatation between the boards arranged along their length (2 mm per 1 linear meter of the board).



Remember about the cutting!

09

Door and window finish

When mounted on a wall with a window, we recommend the use of joists with the dimensions of 20x40mm. This will allow you to cover the entire assembly installation with a masking strip. The plank by the window should be cut to the dimensions of the window opening.



Wooden blocks should be mounted on the joist under the trimmed board, where the masking strips will be screwed.

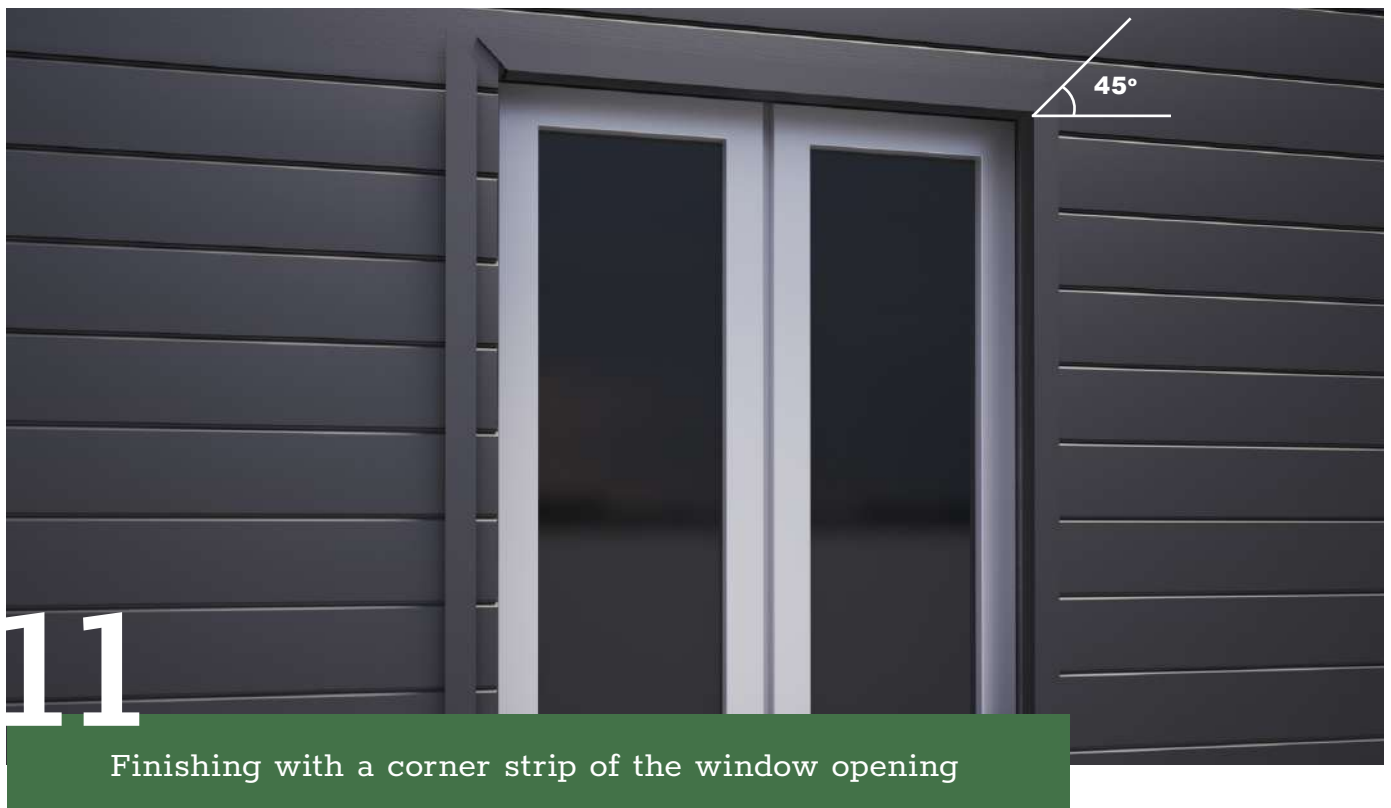

. Wooden blocks 10 Place the batten against the board and then drill holes in the batten and the board from above with a 3 mm metal drill. Countersink the holes with a milling cutter (countersink). Failure to perform the drilling may result in the cracking of the boards. Install the screws on the medium coupling. In the corners, the masking strips should be incised at an angle of 45 degrees.



Finishing with a corner profile

We recommend installing the finishing strip with the assistance of an extra person. Place the batten on the board, and then drill the holes in the batten and in the board from above with a metal drill bit with a diameter of 3 mm. Countersink the holes with a milling cutter (countersink). Failure to perform the drilling may result in the cracking of the boards. Install the screws on the medium coupling at a distance of approx. 350 mm. There must be minimum dilatation between the two battens.

Installation with thermal insulation

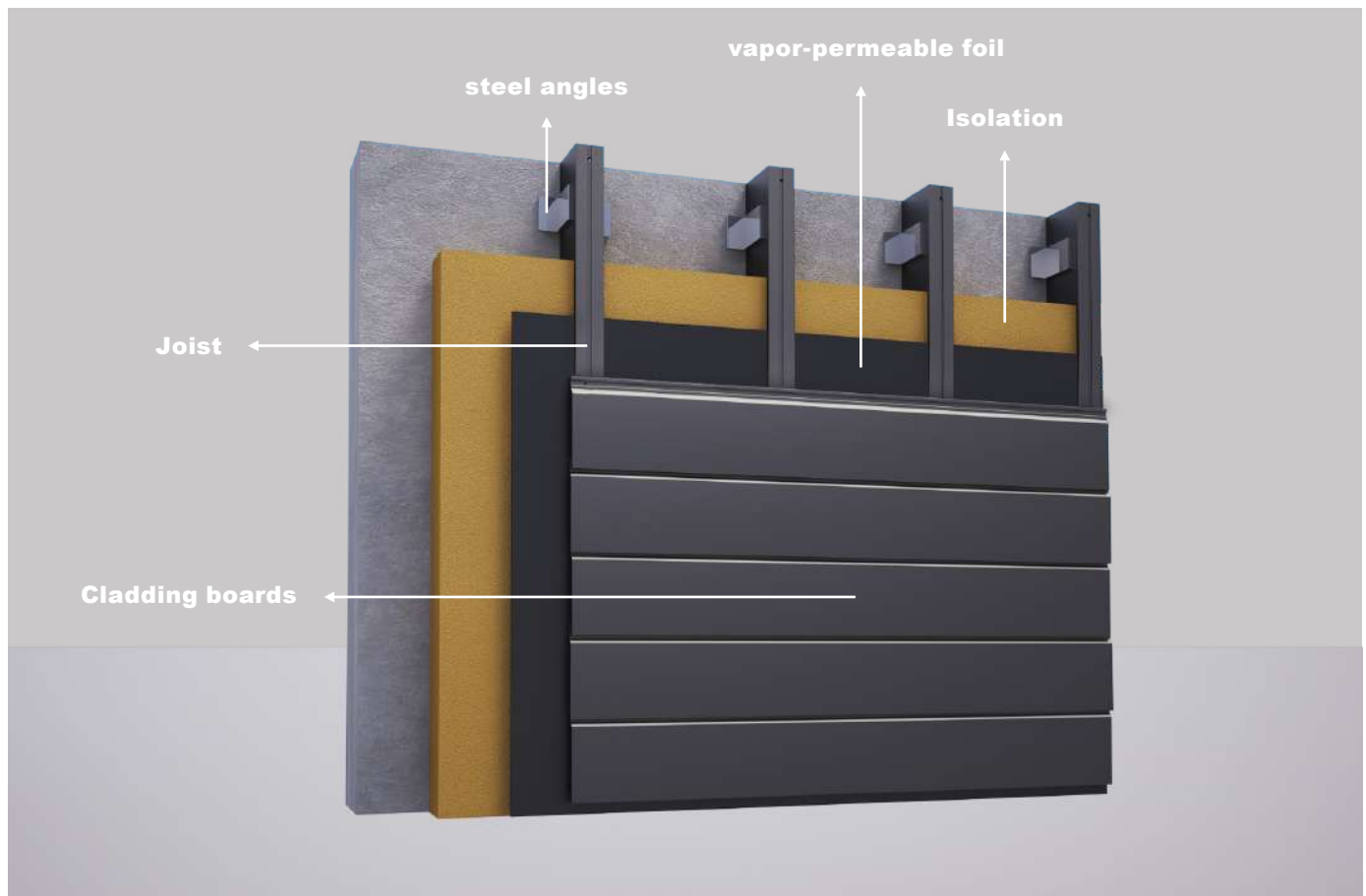

Wooden squared timber (batten) is attached directly to the flooring with the use of steel angles. Install the square at intervals of 350mm. We fill the space between the squared timber with the insulating material. Lay a vapor-permeable foil on the insulation and square timber, so that the insulation can discharge water vapor.

Mount the joists on the foil. Screw them to the square timber. The next steps of the assembly are followed in accordance with the installation instructions for boards presented above.

EcoTRAVERS®

tokada

ANY QUESTIONS?

Contact us.



kontakt@ecotravers.com

www.ecotravers.com